

Installation Instructions

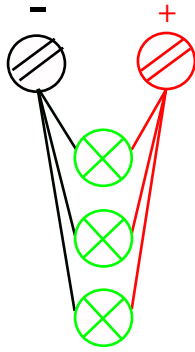

Figure 1

S55



FEATURES

IP67 MR16 & GU/GZ10 Ground Light
Bezel - Stainless steel grade 304
5mm toughened glass
Double glands for loop in - loop out connection
Dual usage - 50w max
5mm toughened glass
Black PVC mounting sleeve supplied
Aluminium body
Cut out 90mm
Depth 125mm
Diameter 96mm

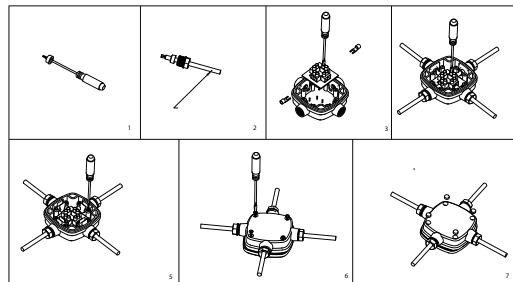

Figure 2



WARNING

If this product is to be used as a mains fitting, it must be supplied 240v from a fused connection unit, and must be earthed. The S55 is rated at IP67 and is suitable for external applications and temporary immersion.

GENERAL

Thank you for purchasing a quality SI-LITE product. This product is designed to be fitted in the ground, indoors or outdoors. This product typically gets hot due to heat generated from the lamp, so it is advisable not to walk with bare feet on the glass, or leave a tyre from a parked vehicle on the glass. This product can be deck mounted.

IMPORTANT INFORMATION

Installation should be carried out in accordance with IEE wiring regulations. Always disconnect the mains supply before installation. Connect the SI-LITE S55 to the mains supply (If using LV option use 12v transformer SI-LITE SET105 before wiring to a mains supply), ensuring that it is protected by a fused connection unit. Make sure all electrical connections are tight. Install the fitting as described below. Never handle hot lamps.

ASSEMBLY INSTRUCTIONS

1. Isolate the mains supply before installation.
2. Unscrew the front bezel and remove lamp holders GX5.3 (12v) and GZ10LH (240v).
3. This product is "dual" usage, meaning it is suitable for either mains voltage (240v) or low voltage (12v).
4. Choose the lamp holder you require (MR16 12v or GU10 240v) and wire to cables inside the product - the lamp holders are polarity free.
5. Insert lamp and screw front bezel back in place.
6. For multiple connections use SI-LITE JBOX1 (IP68 junction box) for parallel wiring, see fig 2. Order JBOX1 separately.
7. Make a suitable waterproof connection in compliance with I.E.E wiring regulations. Connections should be tight with no loose strands and fused connection unit should protect the origin of the circuit.
8. Now you can switch on the supply.
9. If in doubt, contact a qualified electrician.

GUARANTEE

This product is guaranteed for a period of 1 year from the date of purchase. The guarantee is invalid in the case of improper use, improper installation or tampering. Should the product fail during the guarantee period it will be replaced free of charge, subject to correct installation and return of the faulty unit. SI-LITE is not responsible for any costs associated with the replacement of this product.