

## Installation Instructions

SL008

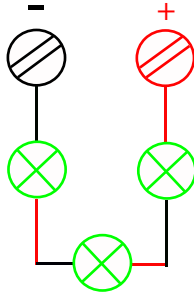

Figure 1



### FEATURES

1w Luxeon LED  
Stainless steel marine grade 316  
IP 65  
5mm toughened glass  
Sealed for life  
15° beam angle  
Cut out 26mm  
Diameter 32mm  
Depth 28mm

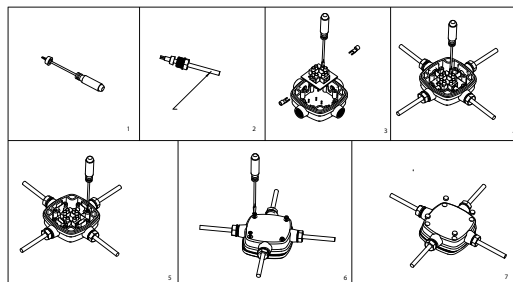

Figure 2



### WARNING

This product must be wired as described below. Incorrect wiring WILL result in irreparable damage to the LED and driver. Read these instructions fully and carefully.

### GENERAL

Thank you for purchasing a quality SI LITE product. This product has been designed, developed and tested to our strict codes & standards. This product is designed to be powered by a constant current driver - SI LITE model SL202W which powers 1-8 x SL008, or SL509 which powers 3-16 x SL008. If wired to a conventional transformer, this fitting WILL be destroyed.

### IMPORTANT INFORMATION

Installation should be carried out in accordance with IEE wiring regulations. Always disconnect the mains supply before installation. Connect the driver to the mains supply ensuring that it is protected by a fused connection unit. Make sure all electrical connections are tight. Install the fitting as described below. Never handle hot lamps.

### ASSEMBLY INSTRUCTIONS

1. Isolate the mains supply before installation.
2. Wire up SL008 in series as shown above - see fig 1.
3. Wire the ends of the series loop from the LED's to your chosen driver, connecting the black wire to the terminal marked - , and the red wire to the terminal marked +
4. For multiple connections use SI LITE JBOX2 ( IP68 junction box ) see fig 2.  
If using an in-line switch, only switch the mains side.
5. Check you have followed these instructions fully - incorrect wiring will result in irreparable damage to the LED's and to the driver. SI LITE performs strict tests on all of our products, and we will not replace products which have been incorrectly wired.
6. Now you can switch on the supply.
7. If in doubt, contact a qualified electrician.

### GUARANTEE

This product is guaranteed for a period of 1 year from the date of purchase. The guarantee is invalid in the case of improper use, improper installation or tampering. Should the product fail during the guarantee period it will be replaced free of charge, subject to correct installation and return of the faulty unit. SI LITE is not responsible for any costs associated with the replacement of this product.



**SI-LITE.COM**  
LIGHTING TECHNOLOGY

**RoHS**  
Compliant

